

Installation guide

Philips EvoKit LED 2x4 and 2x2

This installation guide is only valid for the following Philips EvoKit models :

Products 2x4

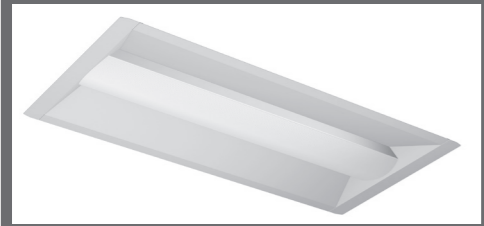

Products 2x2

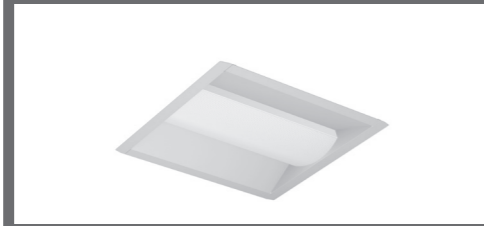

EvoKit	2x4 P	36L xxW	835	2 0-10 7 G2
	2x2 P	23L	830	1 Mk10
	2x4 P	32L	835	2 0-10
		36L	840	2 STEP
		42L		5 Mk10
		52L		

Set contains

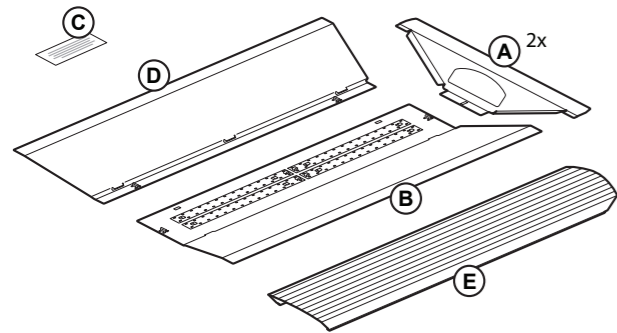

- A Side Panel
- B LED Panel
- C Troffer Label
- D Closing Panel
- E Diffuser

Tools required

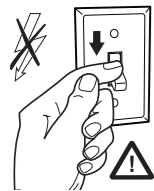
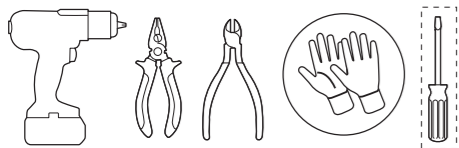

WARNING
RISK OF FIRE, ELECTRIC SHOCK OR PERSONAL INJURY
Before installation, turn power off.

Remove host fixture contents

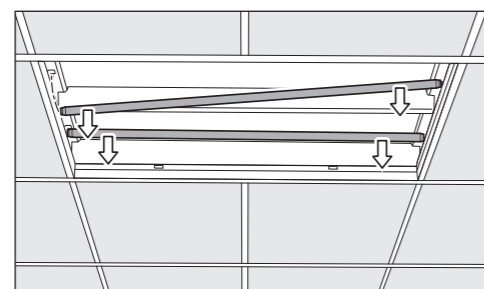
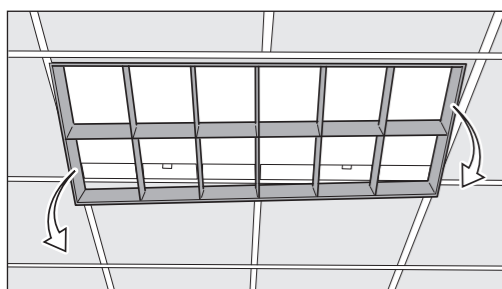

1 Turn power off and take out original cover.

2 Take out TL tubes.

WARNING
FAILURE TO FOLLOW THESE INSTRUCTIONS AND WARNINGS MAY RESULT IN SERIOUS INJURY OR SIGNIFICANT PROPERTY DAMAGE.
For your protection, carefully read these warnings and instructions in their entirety before installing or maintaining this equipment. These instructions do not attempt to cover all installation and maintenance situations. If you do not understand these instructions or if additional information is required, contact your local Philips representative. Retain these instructions for maintenance reference.

WARNING
RISK OF FIRE, ELECTRIC SHOCK OR PERSONAL INJURY
Do not install in a damaged fixture.
Install the EvoKit only in NEMA type G or Type NFG t-grids with a minimum troffer depth of 3".
Before installation, turn power off.

WARNING
RISK OF FIRE OR ELECTRIC SHOCK
To prevent wiring damage or abrasion, do not expose wiring to edges of sheet metal or other sharp objects.

Notice
Do not use abrasive materials, glass cleaners or other solvents on cover plate or lens. To clean the faceplate, use a mild soap solution.
Do not expose the product to substances and /or materials containing sulphur, chlorine or other halogen compounds and to chemicals mentioned in below table.

Category	Chemical Name
Solvents	Toluene, xylene, benzene, chloromethane, chloroform, ethyl acetate, butyl acetate, acetone, MEK, MIBK
Acid	HCl, H ₂ SO ₄ , HNO ₃
Alkali	KOH, NaOH, LiOH, Ca(OH) ₂
Oil	Diesel oil, petroleum, hydro carbons

Caution
This kit is designed for permanent installation in ordinary (Non-Hazardous) locations in accordance with the National Electrical Code and all applicable local codes. Do not use in areas of limited ventilation or in high ambient enclosures.

WARNING
RISK OF FIRE OR ELECTRIC SHOCK
The EvoKit must be installed and maintained by a professional electrician in accordance with the applicable federal, state and local laws, regulations and electrical codes, and the installation instructions provided in this document. This professional should be familiar with the construction and operation of this product and any hazards involved. If not qualified, do not attempt installation. Contact a qualified electrician.

WARNING
RISK OF PERSONAL INJURY
This equipment may have sharp edges. Wear gloves to prevent cuts or abrasions when removing from carton, handling and maintaining this equipment.

WARNING
RISK OF FIRE OR ELECTRIC SHOCK
Luminaire wiring and electrical parts may be damaged when drilling for installation of LED retrofit kit. Check for enclosed wiring and components.

Caution
Do not make or alter any open holes in an enclosure of wiring or electrical components during kit installation except if specifically mentioned in these installation guide.

Notice
Handle components with care. Do not drop, slide or scratch any of the components to prevent visual damage to the product, loss of functionality or difficulties during installation.

Host lighting fixture

The Philips EvoKit is designed for installation in a wide variety of 2x4 and 2x2 indoor fluorescent based fixtures in horizontal applications.

- The Philips EvoKit is non-air handling.
- Install the Philips EvoKit only in fluorescent based host lighting fixtures only with a minimum depth of 3".
- Install the Philips EvoKit only in combination with 15/16" NEMA G or NEMA NFG t-grids.
- Due to the wide variety in troffers and ceiling grids, it is recommended that the installer does a test install before commencing a renovation.
- Please verify voltage on the Philips EvoKit product label matches the mains voltage.

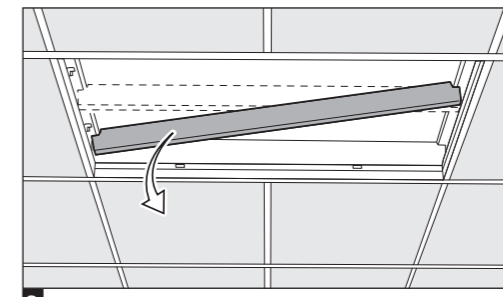

3 Remove belly pan. If remaining troffer height is limited, remove ballast.

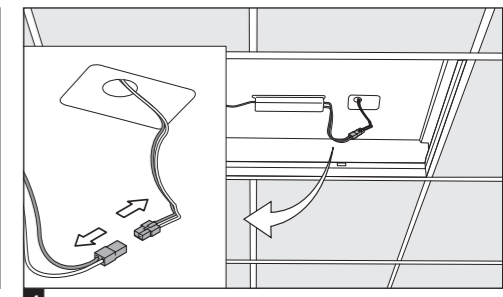

4 Disconnect host fixture ballast from mains.

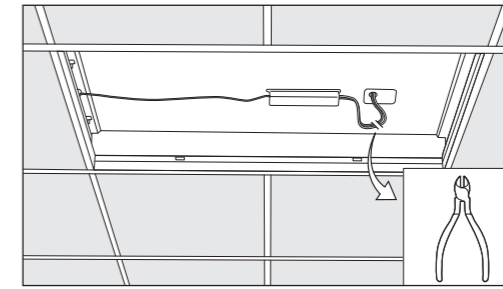

Installation of Side Panels (A)

For SpaceWise accessory, see Spacewise installation instructions.

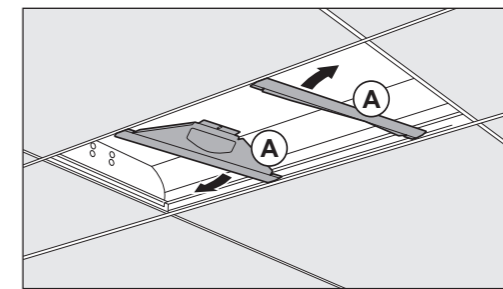

5 Install Side panels (A) in-between troffer and T-grid.

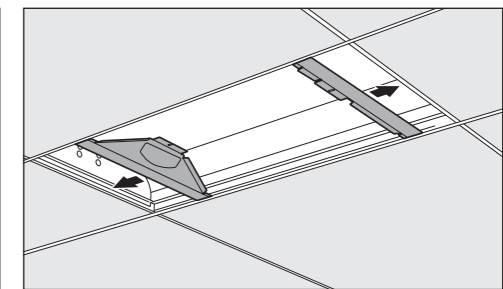

6 Slide Side Panel (A) outwards as far as possible.

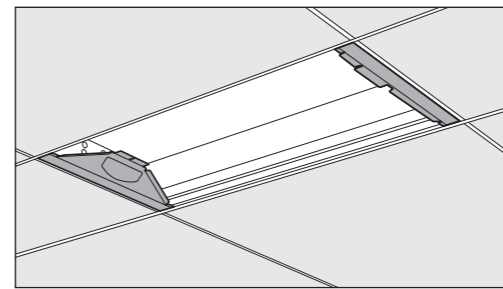

Installation Philips Advance 503441 (Optional)

For installation of the Philips Advance 503441 Emergency LED Driver, please see the emergency driver installation section from this EvoKit manual

Installation LED Panel (B)

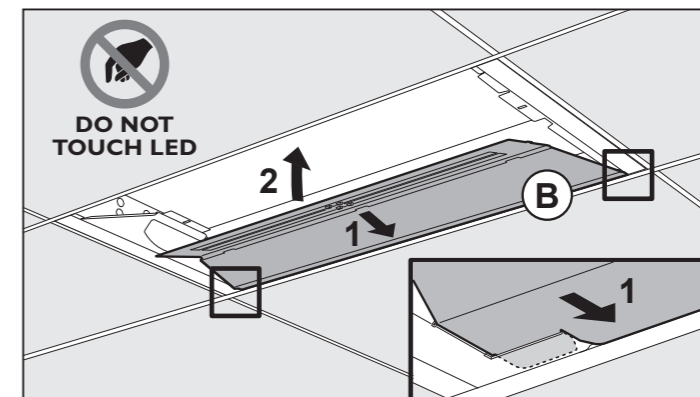

7 Install LED panel (B) in between troffer and T-grid, making sure the tabs at each corner of the LED panel slide into the respective slots on the side panel.

Notice
Do not touch the LEDs with hands or tooling! Touching LEDs can lead to failure of the product.

WARNING
RISK OF PERSONAL INJURY
While installing the LED panel (B) and Closing Panel (D), make sure the electrical wiring is not clamped between panels.

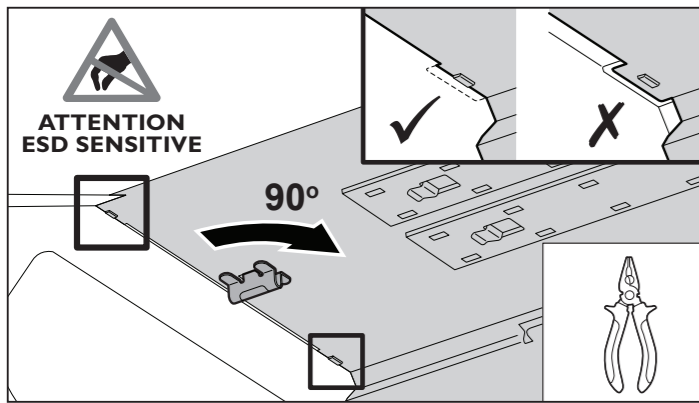

8 Push LED panel upward into position so that the tabs sits above the side panels (this may require a push up on the tabs while pushing outward on the side panels). Fixate panels and establish ground by turning each fastener 90 degrees.

Notice

Do not touch the LEDs with hands or tooling! Touching LEDs can lead to failure of the product.

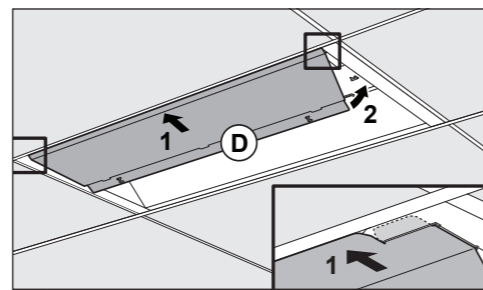

12 Install Closing Panel (D) in-between troffer and T-grid.

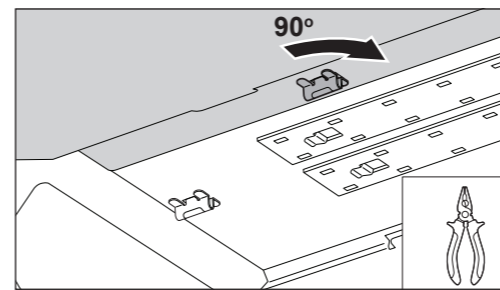

13 Fixate panels and establish ground by turning each fastener 90 degrees.

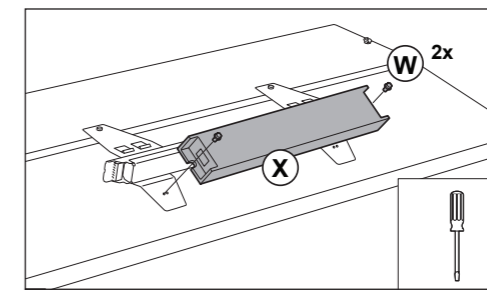

11 Secure 503441 (X) to the back side of LED Panel (B) using two screws (W).

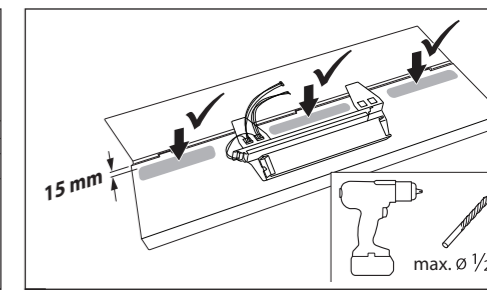

2 Drill 1/2" hole in the LED Panel (B) for installation of LED/test switch on indicated area.

Installation Troffer Label (C)

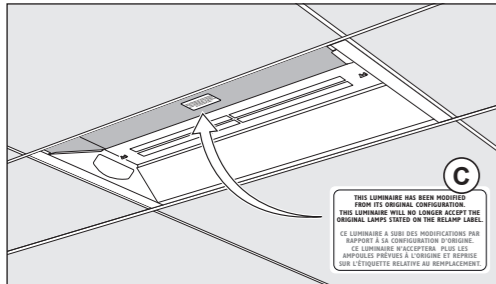

9 Place Troffer Label (C) inside original troffer.

THIS LUMINAIRE HAS BEEN MODIFIED FROM ITS ORIGINAL CONFIGURATION. THIS LUMINAIRE WILL NO LONGER ACCEPT THE ORIGINAL LAMPS STATED ON THE RELAMP LABEL.
CE LUMINAIRE A SUBI DES MODIFICATIONS PAR RAPPORT À SA CONFIGURATION D'ORIGINE. CE LUMINAIRE N'ACCEPTERA PLUS LES AMPOULES PRÉVUES À L'ORIGINE ET REPRISE SUR L'ÉTIQUETTE RELATIVE AU REMPLACEMENT.

Notice

It is imperative to use the retrofit warning sticker included with the product in order to alert the end user that this luminaire will no longer operate on the originally intended lamps.

WARNING
RISK OF FIRE OR ELECTRIC SHOCK
 While installing the LED panel (B) and Closing Panel (D), make sure the electrical wiring is not clamped between panels.

Remove LED protection

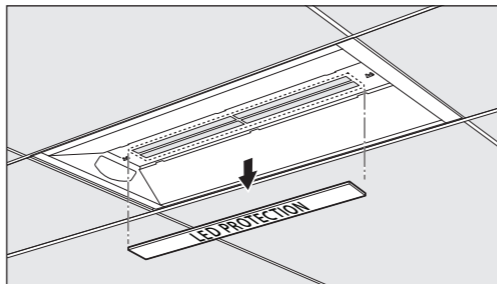

14 Tear off LED protection.

Installation Diffuser (E)

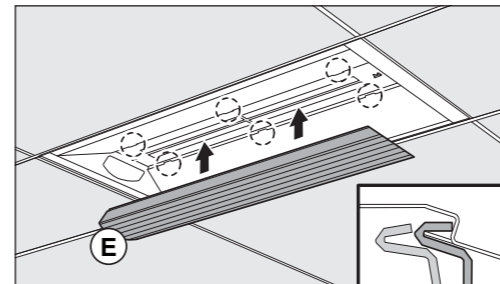

15 Slide Diffuser (E) under the tabs on one side from either Panel and press diffuser (E) over the tabs on opposite panel. The installation is now complete.

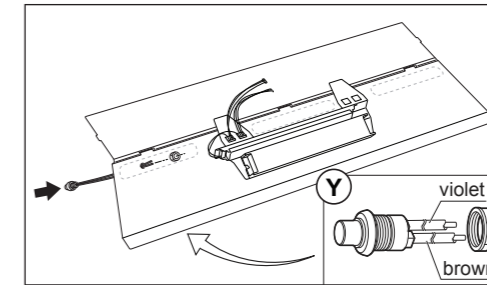

3 Install the test switch by feeding the violet and brown wires through this 1/2" hole and hand tighten the plastic nut included with the test switch/LED combo. Add connect from test switch to wiring harness (Z) (violet - violet, brown - brown).

Notice Ensure an un-switched hot circuit is available to the fixture. This is required for proper emergency fixture operation.

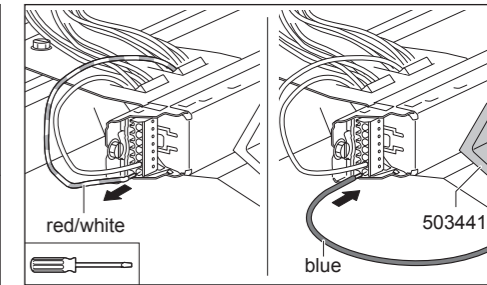

4 Disconnect the red/white single wire from the EvoKit driver. Replace it with the blue output wire from the 503441 (Z). Place a wire nut over the original red/white wire for proper isolation.

Ground connection (Situation 1 - 2)

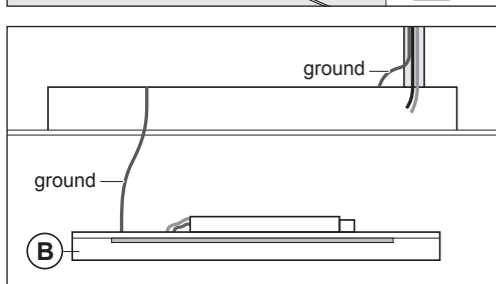
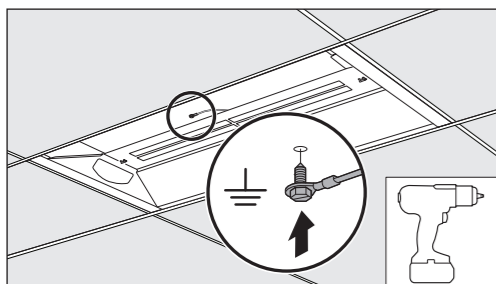

10a Situation 1 Grounding: Screw grounding cable from Led Panel (B) to original troffer if host fixture ground connection is made through host fixture.

WARNING
RISK OF PERSONAL INJURY
 Proper grounding of EvoKit metal parts is required to ensure personal safety.

Notice
 Make new electrical connections to mains by employing applicable connectors in accordance with the applicable federal, state and local laws, regulations and electrical codes.

Connection 0-10V, MK10 dimmer and STEP DIM (Optional)

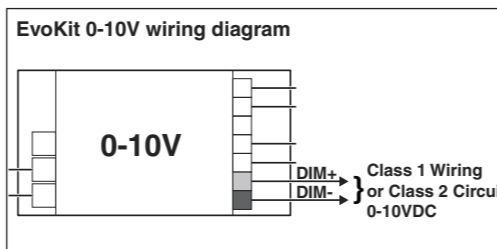

16a Optional: For connection EvoKit 0-10V input, use indicated connections on the driver.

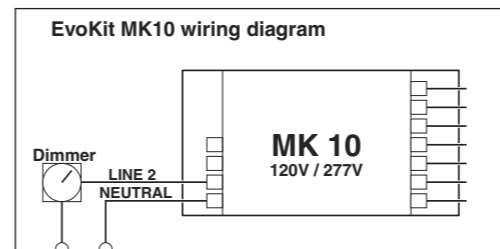

16b Optional: For connection a dimmer to the EvoKit Mark 10, use indicated connections on the driver.

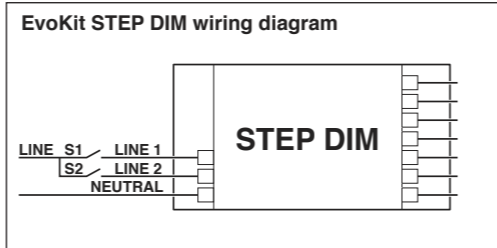

16c Optional: For connection STEP DIM, use indicated connections on the driver.

Notice
 Use 18 AWG Solid Copper Wire Rated >=300V. Strip Wire 3/8"
 In case the EvoKit MK10 277V is installed in combination with a dimmer, use a minimum of 2 EvoKits MK10 277V per dimmer.

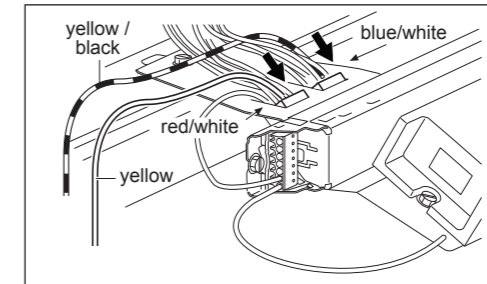

5 Connect the yellow output wire from the 503441 to the EvoKit red/white wire connection block and the yellow/black output wire from the 503441 (Z) to the EvoKit blue/white wire connection block.

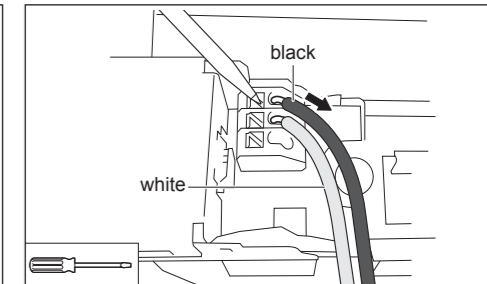

6 Disconnect black wire and insert white/black wire (Z) in the EvoKit driver.

Mains connection

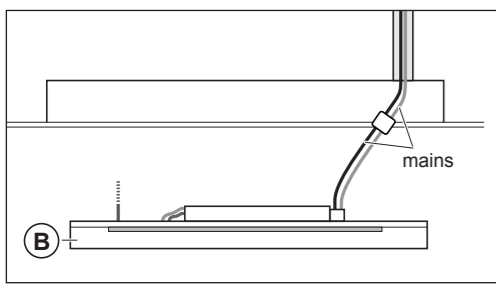

11 Connect main cables and hide connected wires behind LED Panel (B).

Initial installation Philips Advance 503441 Emergency LED Driver (Sold separately)

If the Philips Advance 503441 Emergency LED Driver is to be installed into the EvoKit retrofit fixture, please follow these instructions and the instructions provided with the Emergency driver.

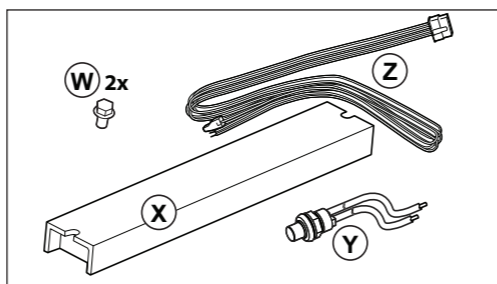

Components: Screws (W), Emergency LED driver (X), Test switch (Y) Wiring harness (Z).

WARNING
RISK OF PERSONAL INJURY
 Ensure all warning and cautionary markings given in the Philips Advance 503441 installation instructions are heeded.

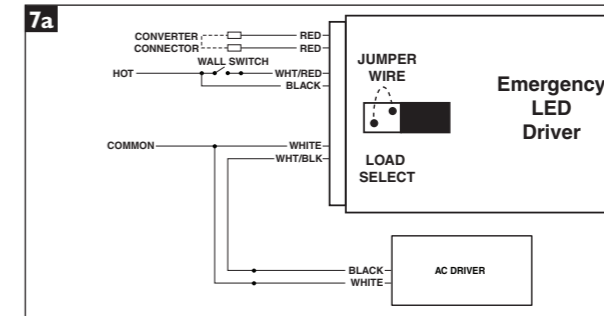

7a Emergency LED driver wiring in combination with **0-10V** and **MK 10** version.
 Connect WHT/RED, BLACK and WHITE (2x) wires (Z) as per the 503441 wiring diagram.
 Connect the 503441 red to red as indicated in schematic (Z).

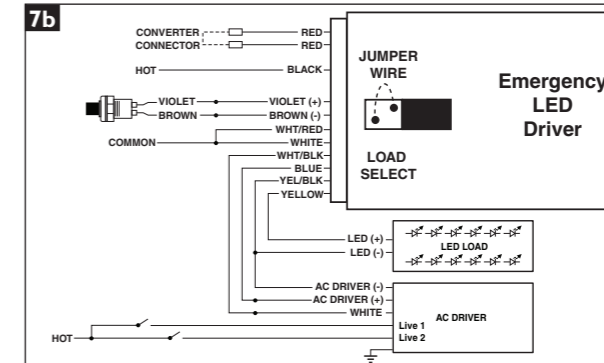

7b Emergency LED driver wiring in combination with **STEP** version.

Notice For the EVOkit, do not connect the jumper wire / load select (yellow/red) on 503441.



© 2013 Philips Lighting Company.
 A Division of Philips Electronics North America Corporation.
 All rights reserved.
 Printed in USA 9/14

www.philips.com
 20140519

Philips Lighting Company
 200 Franklin Square Road
 Somerset, NJ 08873
 1-800-555-0050

443529060851 REV. C

Philips Lighting
 281 Hillmont Road
 Markham, Ontario
 Canada, L6C 2S3
 1-800-555-0050
 A Division of
 Philips Electronics Ltd.